

Parallel connectors

For splicing or connecting wires together. Parallel connectors are crimped in two places; one crimp for each wire. Made from electrolytic tin plated copper. Available in 10 - 1000 mm² wire sizes.

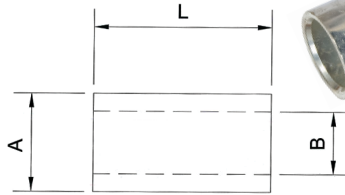

Parallel connectors					
Cable size (mm ²)	Part number	Dimensions (mm)			Pack quantity
		A	B	L	
10	CCT10 PS	6.9	4.6	9.0	1
16	CCT16 PS	8.0	5.6	14.0	1
25	CCT25 PS	9.5	7.0	16.0	1
35	CCT35 PS	11.0	8.2	18.0	1
50	CCT50 PS	12.1	9.5	20.0	1
70	CCT70 PS	15.0	11.5	23.0	1
95	CCT95 PS	17.0	13.5	26.0	1
120	CCT120 PS	19.0	15.0	31.0	1
150	CCT150 PS	21.0	16.5	32.0	1
185	CCT185 PS	23.0	18.5	36.0	1
240	CCT240PS	26.0	21.0	39.0	1
300	CCT300 PS	28.0	23.0	43.0	1
400	CCT400 PS	32.0	27.0	44.0	1
500	CCT500 PS	38.1	30.0	66.0	1
630	CCT630 PS	44.0	33.0	66.0	1
800	CCT800 PS	49.0	38.0	66.0	1
1000	CCT1000 PS	53.0	42.5	66.0	1

Dissimilar copper splices

Dissimilar splices are designed for joining cables of dissimilar cross sectional areas. They are available to order to fit voltage conductors from 1.5mm² to 1000mm². When enquiring, specify the cross sectional area of both conductors.

technical@cablecraft.co.uk

